

August 2011

# THE DOCK

## Press Release

### Multiplex at The Dock for London Design Festival 2011

#### Portobello Dock

344 Ladbrooke Grove, London, W10 5BU

19<sup>th</sup> – 25<sup>th</sup> September 2011

Monday – Saturday 10am – 6pm

Thursday - Late night shopping – 8pm

Sunday 10am – 4pm



Set on an industrial waterside estate, **The Dock**, hosted by Tom Dixon and sponsored by Derwent London, is rapidly turning into an epicentre for design and innovation. During the September festival expect indoor, outdoor and water-based installations, exhibitions and workshops from exhibitors such as **Aston Martin**, **Moooli**, **Innocent Drinks** and **UP Projects' Floating Cinema** as well as the launch of **Kitchenette**, The Dock Kitchen's lunch-time extension.

#### WHARF BUILDING

Tom Dixon launches new lighting designs including **Bulb**, an energy efficient oversized light bulb with a quick start T5 dimmable bulb. The **Mini Void** is a development of the Void series and references the Olympic Games medals. The new **Etch** Light is digitally etched in brass and fitted with tiny energy efficient LED lights.

The **Tom Dixon Shop** showcases the full Tom Dixon range of lighting and furniture. Tom has also handpicked an international mix of concession brands including Dutch designer **Piet Hein Eek** and **Sort Of Coal**. New additions include knit-wear designer **Hikaru Noguchi** and **Present and Correct**, who sell their globally sourced stationary in the shop throughout the week.

Situated below decks, **Kitchenette** is launched by Dock Kitchen serving a selection of salads, sandwiches and coffees.

**Print Club London** set up their unique gallery and studios, creating and selling signed limited edition silk screen prints and showcasing new prints from the biggest names in UK illustration and graphic design. Resident printers **James Joyce**, **Anthony Burrill** and east London graffiti artist **Pure Evil** are on hand all week signing prints and discussing works.

**Ariane Prin** runs a production line of her project From Here For Here. Using sawdust from Tom Dixon's workshop and purpose built wood moulds, the RCA graduate creates fully functioning drawing pencils available for visitors to buy.

**Fine Cell Work**, the charity that teaches British prisoners the craft of needlework to make witty cushions, throws and bags, host a workshop in the Tom Dixon Shop at 4pm on Thursday. Visitors are taught by an ex-inmate how to make their own Love inspired pin cushions using vintage fabrics.



DERWENT  
LONDON

THE  
LONDON  
DESIGN  
FESTIVAL

## TERRACE AND OUTDOOR AREA

On the terrace **Dock Kitchen Market** sells fresh produce from a collection of carefully sourced suppliers while Stevie Parle serves up lunch, dinner and tea at the renowned **Dock Kitchen**.

British sports car manufacturer **Aston Martin** create a dramatic trail of their latest model range, including the marque's luxury city car, the Cygnet, at the entrance to The Dock. Visitors can see designs up close, talk to experts and take a seat behind the wheel.

**Fold a boat** is a flat-pack folding boat made from a single sheet of plastic large enough to carry two adults. A number of the boats, designed by RCA graduates Max Frommelt and Arno Mathies, are moored in the canal basin for visitors to trial on the water.

## CANAL BUILDING

In their new HQ, Fruit Towers, **Innocent Drinks** host Fruit for Thought, a retrospective of their in-house design and history of the innocent branding. They also sell copies of the new Innocent recipe book, *Hungry?*

## THE WHITE BUILDING

**Timothy Hatton Architects** unveil a free-standing pavilion built in collaboration with Concrete Canvas – an award-winning textile material which hardens once saturated with water. Inside, the architects exhibit their ideas for using this material in disaster relief zones.

**The Floating Cinema** is an extraordinary customized narrow boat moored on the Grand Union Canal hosting a vibrant programme of daily on-board screenings. Created by Hackney-based architecture practice Studio Weave and artist duo Somewhere for Portavillion 2011 by UP Projects.

Dutch design company **Moooi** host a debut exhibition of Marcel Wanders' most recent art project, Moooi Mermaids. Moooi theme their gallery as a mythical underwater world to showcase this latest collection.

Upstairs in the White Gallery **Designers in Residence**, a collective of Northumbria University alumni, showcase their project, Tools For Daily Life.

For more information, hi-res images and interview requests please contact Rebecca Price E: [press@tomdixon.net](mailto:press@tomdixon.net) or T: +44 (0)20 183 9723. All material is available to download from our website [www.tomdixon.net](http://www.tomdixon.net)

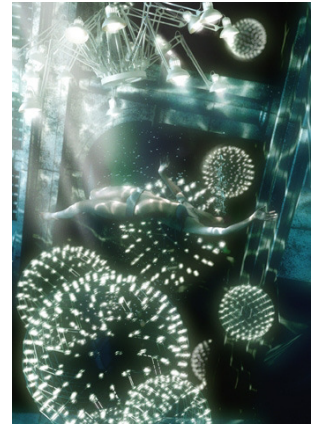
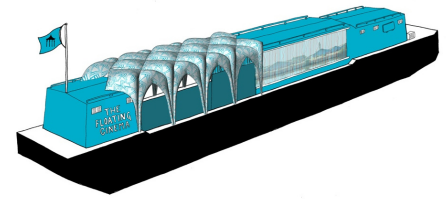

### WHARF BUILDING

#### Ground Floor

**Ariane Prin** – [www.arianeprin.com](http://www.arianeprin.com)  
**Ateliers Ruby** – [www.ateliersruby.com](http://www.ateliersruby.com)  
**Cire Trudon** – [www.ciretrudon.com](http://www.ciretrudon.com)  
**Fine Cell Work** – [www.finecellwork.co.uk](http://www.finecellwork.co.uk)  
**Grasilver** – [www.grasilver.com](http://www.grasilver.com)  
**Guri Elbaekgaard** – [www.elbaekgaard.dk](http://www.elbaekgaard.dk)  
**Hikaru Noguchi** – [www.hikarunoguchi.com](http://www.hikarunoguchi.com)  
**Kitchenette** – [www.dockkitchen.co.uk](http://www.dockkitchen.co.uk)  
**Made A Mano** – [www.madeamano.com](http://www.madeamano.com)  
**Piet Hein Eek** – [www.pietheineek.nl](http://www.pietheineek.nl)  
**Present and Correct** – [www.presentandcorrect.com](http://www.presentandcorrect.com)  
**Print Club London** – [www.printclublondon.com](http://www.printclublondon.com)  
**Simon Hasan** – [www.simonhasan.com](http://www.simonhasan.com)  
**Sort of Coal** – [www.sortofcoal.com](http://www.sortofcoal.com)  
**Stephen Rohholz** – [www.tomdixon.net](http://www.tomdixon.net)  
**Teixidors** – [www.teixidors.com](http://www.teixidors.com)  
**Tom Dixon Shop** – [www.tomdixon.net](http://www.tomdixon.net)

#### First Floor

**Dock Kitchen** – [www.dockkitchen.co.uk](http://www.dockkitchen.co.uk)

#### Terrace and Outdoor Area

**Aston Martin** – [www.astonmartin.com](http://www.astonmartin.com)  
**Dock Kitchen Market** – [www.dockkitchen.co.uk](http://www.dockkitchen.co.uk)  
**Innocent** – [www.innocentdrinks.co.uk](http://www.innocentdrinks.co.uk)  
**Max Frommelt and Arno Mathies** – [www.ma-fro.com](http://www.ma-fro.com)

### WHITE BUILDING

#### Outside and Grand Union Canal

**Floating Cinema** – [www.floatingcinema.info](http://www.floatingcinema.info)  
**Timothy Hatton Architects** – [www.that.co.uk](http://www.that.co.uk)

#### Ground Floor

**Moooi** – [www.moooi.com](http://www.moooi.com)  
**Senso** – [www.sensofloors.co.uk](http://www.sensofloors.co.uk)

#### White Gallery

**Designers in Residence** – [www.designersinresidence.org](http://www.designersinresidence.org)

#### Note to editors:

- Derwent London is one of London's most innovative office specialist property regenerators and investors and owns and manages a portfolio of properties which includes Portobello Dock. For more information please see [www.derwentlondon.com](http://www.derwentlondon.com)

-The Floating Cinema is commissioned by the Olympic Delivery Authority and funded by the Arts Council England for Portavillion 2011, UP Projects on-going programme of artists pavilions for London's public spaces

- Moooi Imagery copyright to Marcel Wanders Studio