

TEA

The Tea Building used to be full of tea.

Now it's full of ideas.

5,380 sq ft available.





One of London's most iconic
buildings and a destination
for creative occupiers.



Tea Building is perfectly
placed in the heart of
Shoreditch, an area always
evolving, always exciting,
bursting with restaurants,
talent and new ideas.

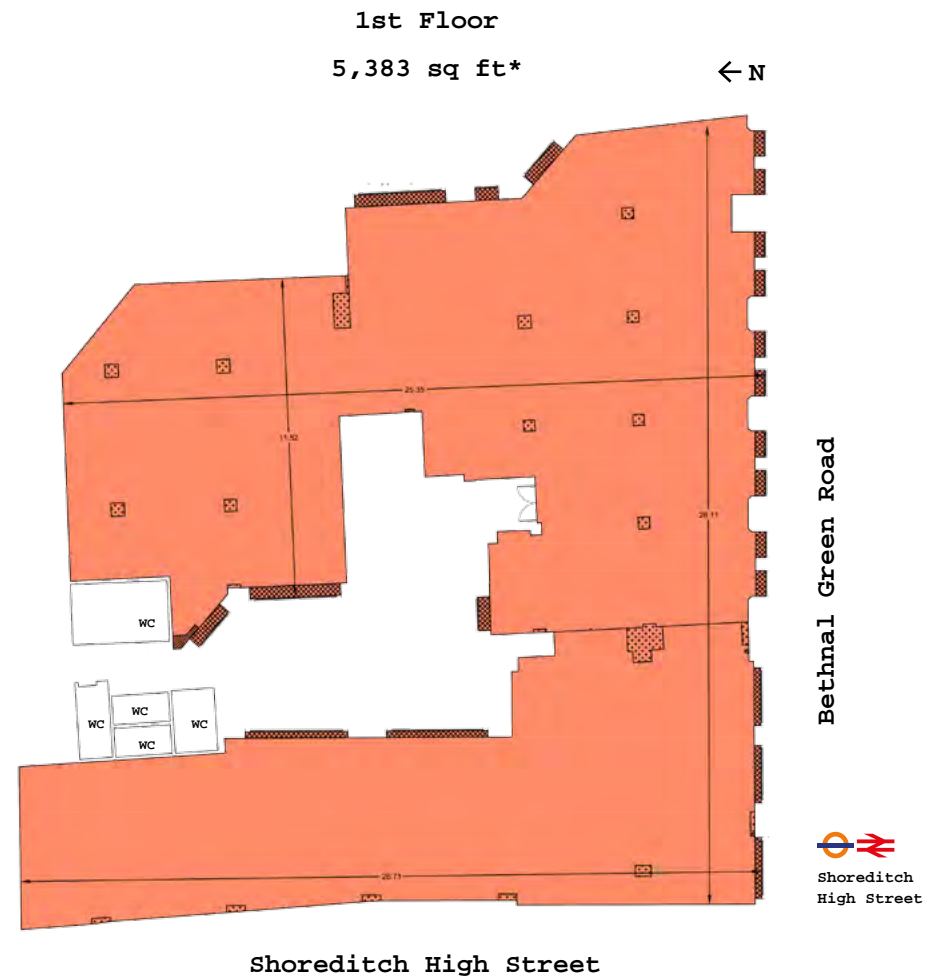

*Subject to measurement. IPMS measurements on request





Home to a variety of
talented and innovative
tenants including Albion,
Buckley Gray Yeoman,
Fetch, Method, Mother,
Shoreditch House,
Transferwise and ustwo.



For further information please contact the agents:

Colliers International
020 7101 2020

Shaun Simons
shaun.simons@colliers.com

Michael Raibin
michael.raibin@colliers.com

Oliver Jay
oliver.jay@colliers.com

Pilcher Hershman
020 7399 8600

David Jackson
davidjackson@pilcherhershman.co.uk

Simon Rinder
simonrinder@pilcherhershman.co.uk

Julian Wogman
julianwogman@pilcherhershman.co.uk

Misrepresentation Act

Whilst every effort has been made to ensure accuracy, no responsibility is taken for any error, omission or mis-statement in these particulars which do not constitute an offer or contract. No representation or warranty whatever is made or given either during negotiations or in particular by the vendor, lessors or agents Messrs Colliers International and Pilcher Hershman. All figures are exclusive of rates, service charge, VAT and all other outgoings. The agents have not tested the services. All floor areas are approximate. Date of preparation February 2017.



56 Shoreditch High Street E1
teabuilding.co.uk



@TeaBuilding

DERWENT
LONDON